

1 Bed Apartment

£179,950 Leasehold

Hilton Street, Manchester, M1

Key Features

Huge Bedroom • Grade II Listed Building • Original Sash Windows • Prime Northern Quarter Location • Stunning Period Features • Secure parking • Currently let at £1,100 pcm

Full Description

Currently tenanted at £1,100 pcm

We are pleased to offer for rent this charming one bedroom apartment, in the heart of the Northern Quarter. The apartment has a fully integrated, open plan kitchen living area, boasting corner aspect sash windows. There is a large bathroom with a shower over the bath and a huge bedroom, again benefitting from original windows. One secure parking space is included.

This dramatic, grade II listed building has a stunning stairwell with the original beams and coloured Victorian tiles. The building is set on Hilton Street which is a stones throw from the transport links of Picadilly station and is positioned near many shops and bars.

Lease length - 250 years
 Lease start date - 14th June 2007
 Service charge - £2940.84 per annum.
 Ground rent - £100 per annum
 A1 rated EWS1

308 Langley Building, 36 Hilton Street Manchester, M1 2EH

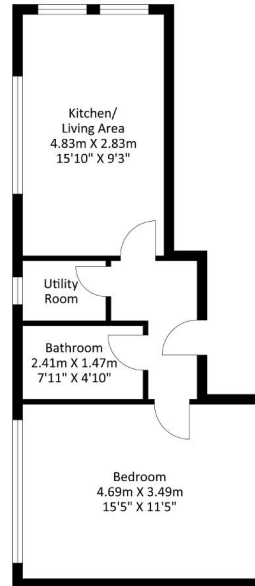

Approximate Floor Area
 433.78 sq. ft
 (40.30 sq.m)

Approximate Gross Internal Area = 40.30 sq m / 433.78 sq ft
 Illustration for identification purposes only, measurements are approximate, not to scale.

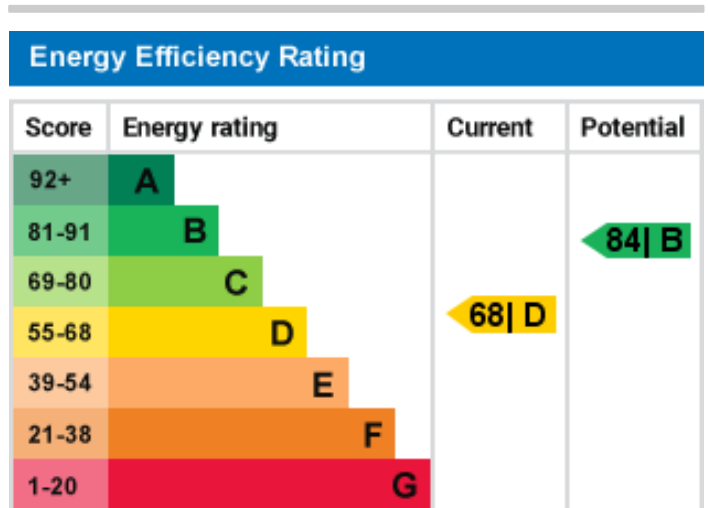

Strict Codes of Practice

Townhouse Lettings is a member of The Property Ombudsman, and complies with the Tenancy Deposit Protection Scheme. These memberships provide landlords and tenants with an assurance that they will receive the highest level of customer service.