



2 Bed Flat

£247,500 Leasehold

Tuscany House, Manchester, M1

Key Features

2 Double Bedrooms • Sought After Central Location • Wooden Floors Through • Two bathrooms • Spacious and Bright • Corner aspect

Full Description

On offer is a superb two bedroom apartment in the popular Tuscany House development, just next to China Town in the very heart of Manchester city centre. The apartment briefly comprises a large open plan kitchen and living area, two large double bedrooms, one with an en suite that features a walk in power shower, and a large bathroom with bath tub.

For more information or to book a viewing please contact Townhouse Lettings today. Parking Space available for an additional cost.

24 Tuseany House, Manchester, M1 4LX

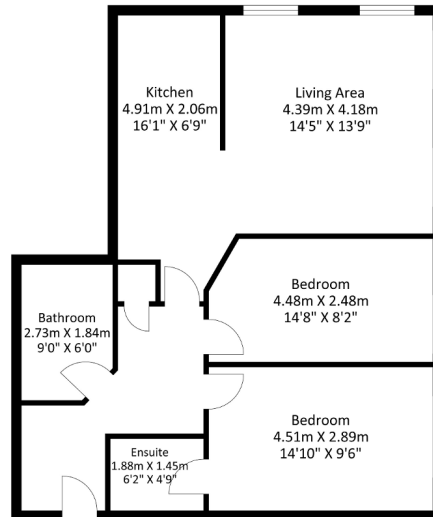

Approximate Floor Area
 782.53 sq. ft
 (72.70 sq.m)

Approximate Gross Internal Area = 72.70 sq m / 782.53 sq ft
 Illustration for identification purposes only, measurements are approximate, not to scale.

