



**6 Bed Semi-Detached**

**£4,030 per month**

Parrs Wood Road, Manchester, M20

**Key Features**

6 Bed student house • All bills included • Fantastic Location • Large rear garden • Semi detached • Off road parking

## Full Description

All Bills Included.

Right on the Parrswood Road with regular buses into the city and the universities, a big fully equipped open plan living space with everything you need to relax, socialise, entertain and cook meals to enjoy with friends and housemates! All good sized well furnished double rooms, 2 bathrooms with a garden at the back with off road parking located in the popular residential student area of Withington.

Available 1st July 2024

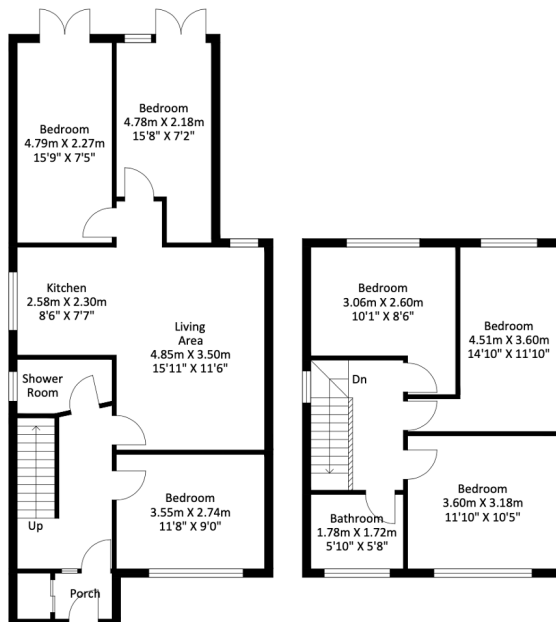

Ground Floor  
Approximate Floor Area  
764.23 sq. ft  
(71.0 sq.m)

First Floor  
Approximate Floor Area  
489.75 sq. ft  
(45.50 sq.m)

Approximate Gross Internal Area = 116.50 sq m / 1253.99 sq ft  
Illustration for identification purposes only, measurements are approximate, not to scale.

### Energy Efficiency Rating

Score	Energy rating	Current	Potential
92+	A		
81-91	B		
69-80	C		78   C
55-68	D	64   D	
39-54	E		
21-38	F		
1-20	G		