



Studio

£124,950 Leasehold

Church Street, Manchester, M4

Key Features

Studio Apartment • Fantastic Location • Balcony • 8th Floor • Council tax band A • B1 rated EWS1 • Separate Kitchen

Full Description

Townhouse are pleased to offer for sale this studio apartment located on in the sought after Pall Mall building on Church street in the heart of the City Centre.

The property compromises of an entrance hallway, bathroom fitted with a 3 piece suite with a shower overhanging the bath, kitchen with dishwasher, oven and hobs and a fridge freezer. Towards the back of the property is the livingroom/bedroom which has a fitted wardrobe and access to the balcony.

Please contact Townhouse today for a viewing

Council tax band A

Ground rent (yearly) - £200 per annum

Lease 125 years commencing 8th September 2006

B1 rated EWS1

Church Street, Manchester Total Approx. Floor Area 316 Sq.ft. (29.4 Sq.M.)

Surveyed and drawn by Lens Media for illustrative purposes only. Not to scale. Whilst every attempt was made to ensure the accuracy of the floor plan, all measurements are approximate and no responsibility is taken for any error.

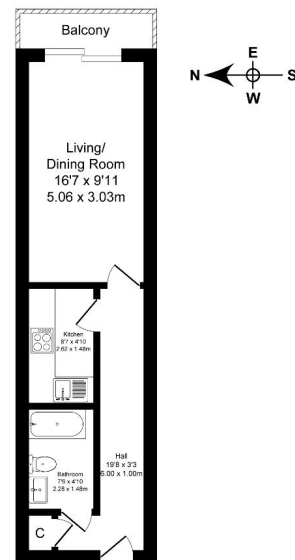

Approx. Floor Area 316 Sq.Ft (29.4 Sq.M.)

Score	Energy rating	Current	Potential
92+	A		
81-91	B	86 B	87 B
69-80	C		
55-68	D		
39-54	E		
21-38	F		
1-20	G		