

2 Bed Apartment

£1,275 per month

Stretford Road, Manchester, M15

Key Features

Stunning 2 bed Apartment • Available immediately • Two Bathrooms • Fully furnished • Balcony • First floor apartment

Full Description

We are pleased to offer this stunning two bedroom, two bathroom apartment, in the Aaben Development. A fantastic development of 105 homes, located on Leaf Street in Hulme. The Aaben was the first One Living development by One Manchester, a not for profit organisation providing homes and community services in Manchester. One Manchester's aim is to create communities that are safe, happy and prosperous places to live. All money raised will go into funding other One Manchester projects. You will be able to rent your home for as long as you need to, giving you both security and peace of mind.

With a combination of 1, 2 and 3 bedroom apartments as well as 3 bedroom townhouses these properties are within easy reach of Manchester city centre and with on-site green open spaces. Each property has been designed with quality, comfort and energy-efficiency in mind; meaning homes are built to last, will be better for the environment and will reduce your bills.

This apartment has a spacious internal layout with an abundance of natural daylight. It briefly comprises of an open plan kitchen and living area, balcony to the front of the property, two double bedrooms, one at each side of the living area, a large en suite with a shower over the bath and a separate bathroom with shower and toilet.

Each property is finished to a high standard, featuring wood effect flooring in the living area and hallways as well as carpets in all bedrooms. The kitchen has contemporary high gloss fitted furniture, oak coloured worktops complemented by wall tiling. Every apartment has an integrated washer dryer, a large fridge freezer, integrated dishwasher, hob, cooker hood and oven.

Additional benefits with this apartment include underfloor heating, lifts to all floors and secure cycle storage.



Strict Codes of Practice

Townhouse Lettings is a member of The Property Ombudsman, and complies with the Tenancy Deposit Protection Scheme. These memberships provide landlords and tenants with an assurance that they will receive the highest level of customer service.

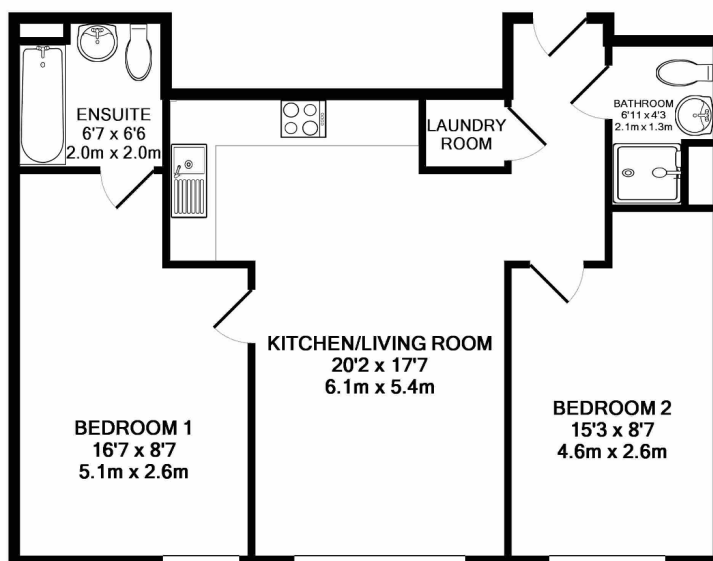

TOTAL APPROX. FLOOR AREA 657 SQ.FT. (61.0 SQ.M.)

Whilst every attempt has been made to ensure the accuracy of the floor plan contained here, measurements of doors, windows, rooms and any other items are approximate and no responsibility is taken for any error, omission, or mis-statement. This plan is for illustrative purposes only and should be used as such by any prospective purchaser. The services, systems and appliances shown have not been tested and no guarantee as to their operability or efficiency can be given
 Made with Metropix ©2017